

# KALLER®

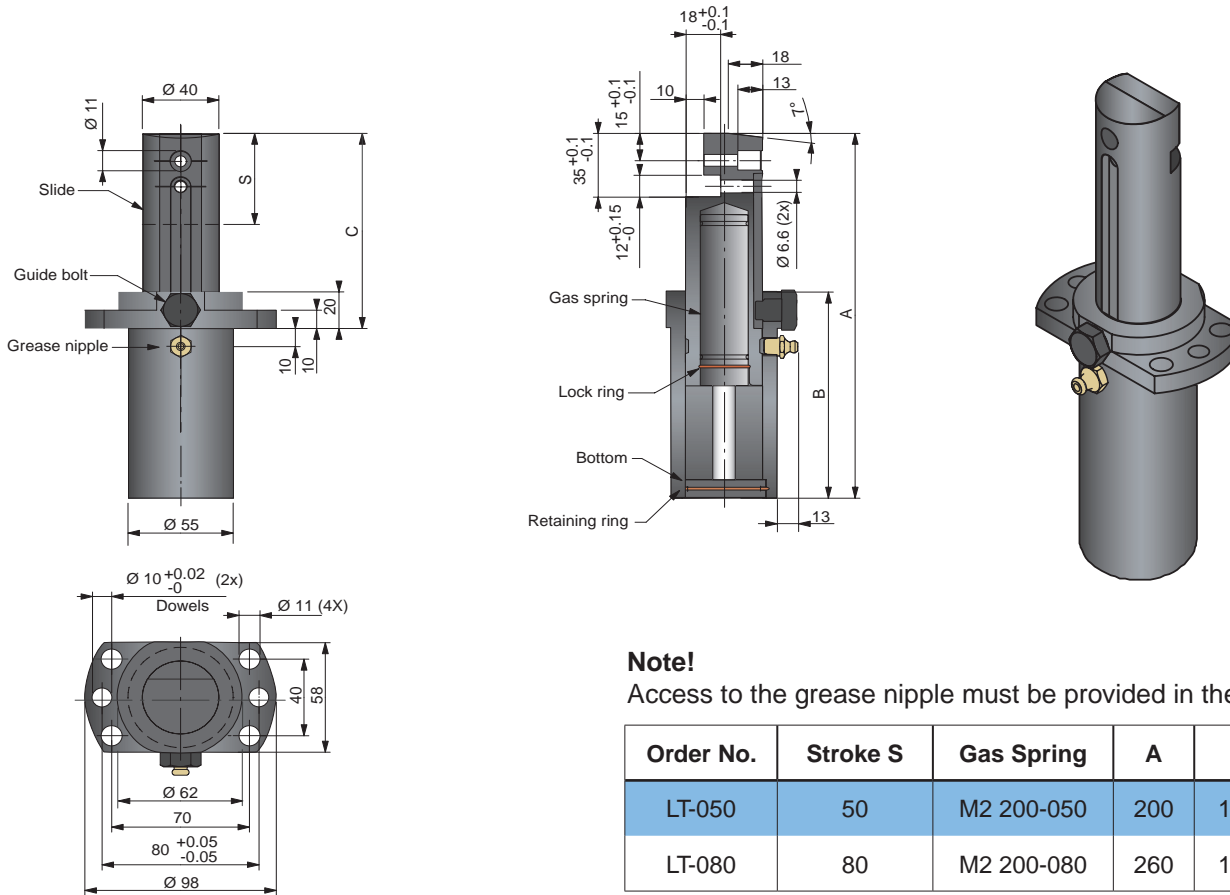

**Flange Stripper LT, LW**

## Dimensions LT - Top Mount



## Dimensions LW - Wall Bottom Mount

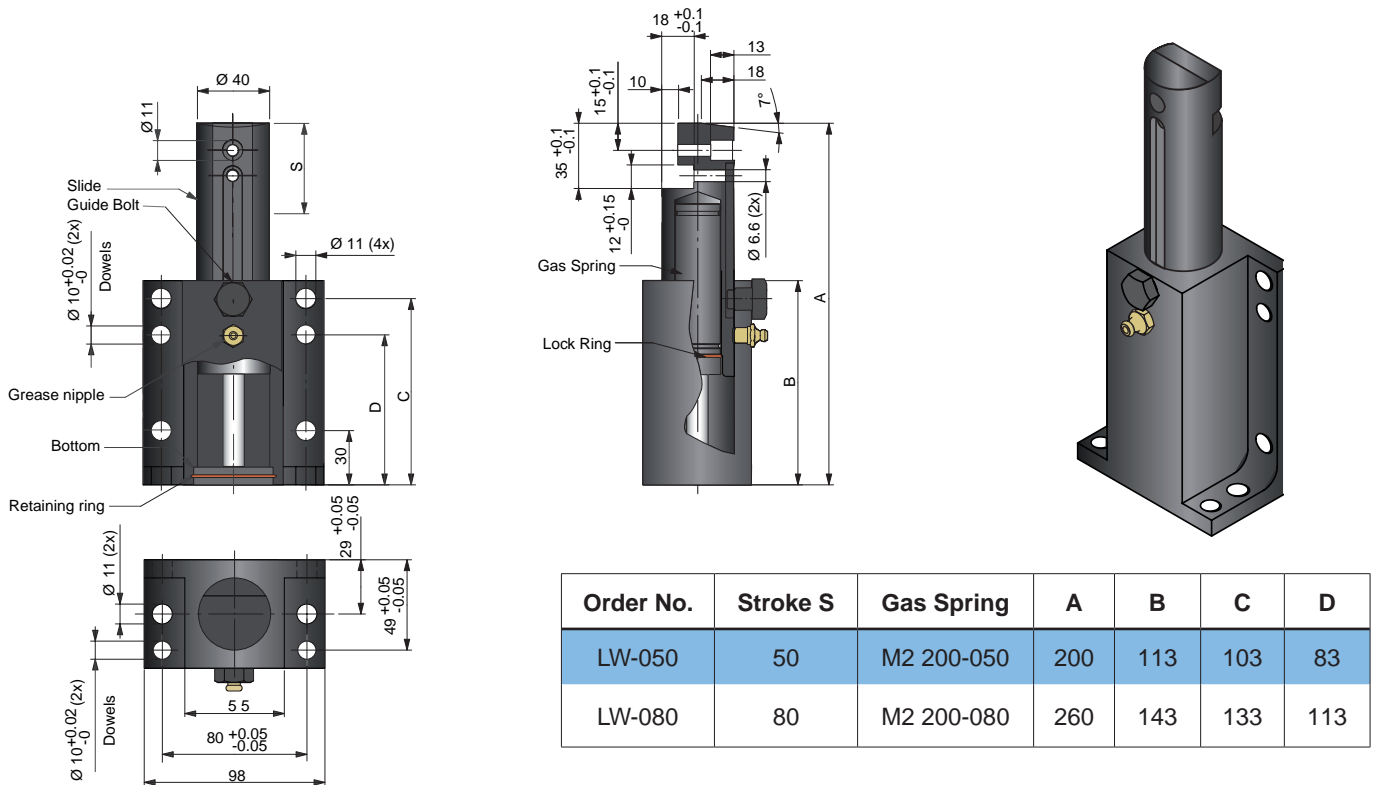

We reserve the right to add, delete or modify components without notification.

All dimensions are stated in mm.  
All dimensions are nominal unless tolerance is stated.

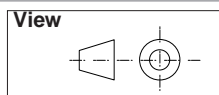

## Flange Stripper LT, LW

The Flange Stripper is for use in flanging dies for stripping the part after the flanging operation. It is available for top mount and wall/bottom mount, with stroke lengths of 50 and 80 mm.

The Flange Stripper's stripping force is provided by an M2 Gas Spring with an initial force of 200 daN. The Gas Spring is inverted and fitted into the Flange Stripper.

During try-out and maintenance, the Slide and/or gas spring can easily be removed by unscrewing the Guide Bolt. Once the Guide Bolt is unscrewed, the Slide can be lifted up and the gas spring removed. The Slide can now be replaced and operated by hand during try-out.

The Flange Stripper is equipped with a grease nipple, which after initial greasing should be greased every 100'000 strokes.

The Stripper Plate and the Blank Stop is to be manufactured by the tool maker to the desired profile and attached to the Flange Stripper using an M6 bolt.

## Mounting options

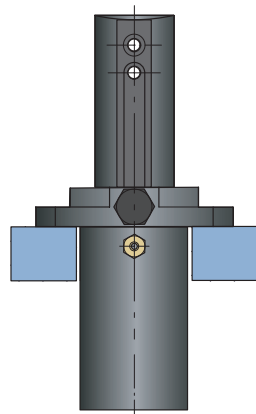
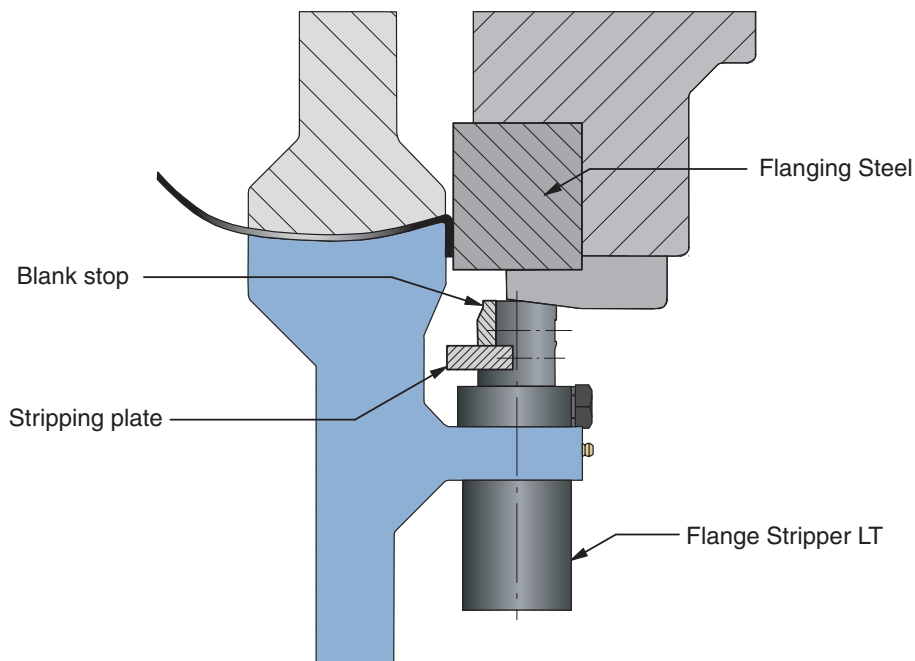

LT - Top mount

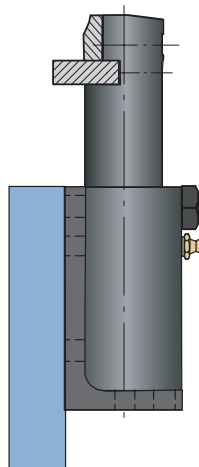

LW - Wall mount

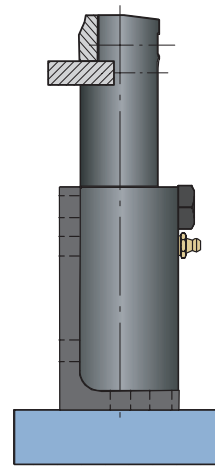

LW - Bottom mount

# KALLER®

## The Safer Choice

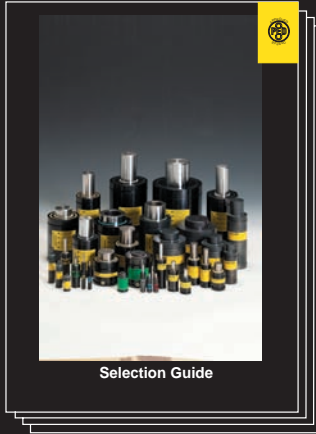

### Gas Springs

Kaller developed the first nitrogen gas spring for press tools and today offers a comprehensive selection of high quality gas springs for use in different tool & die applications.

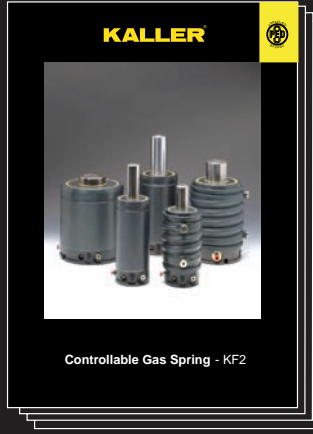

### Controllable Gas Springs-KF2

Kaller controllable springs are a family of gas springs, for use in press tools, that can be locked in their bottom position and where the return stroke of the spring can be controlled.



### Flange Stripper Unit

Kaller Flange Stripper Unit is used in flanging dies for stripping/lifting a flanged part after forming. It provides 200 daN of stripping force, can be top or bottom mounted and is self guiding.

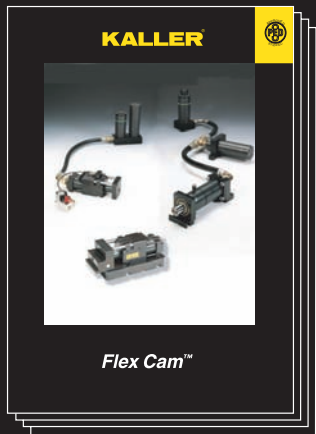

### Flex Cam™

The Flex Cam is used for piercing, cutting, forming and flanging operations. The system allows for a flexible distribution of forces with optimal direction and velocity. By using a Flex Cam, fewer tools are required in production.



### Roller Cam

Kaller Roller Cam is used for piercing, trimming, flanging and restriking. The Roller Cam can be mounted in both vertical and horizontal angles.

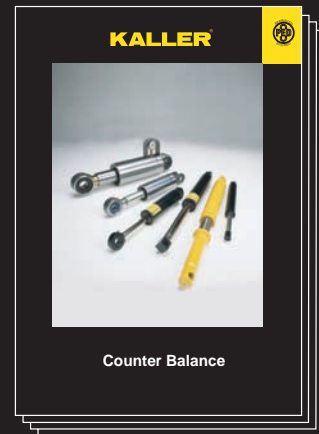

### Counter Balance

Kaller Counter Balance gas springs can be used to lift, lower, assist, balance, and hold in a multitude of applications.

# KALLER®

Strömsholmen AB

Box 216 • SE-573 23 Tranås

Sweden

Phone +46 140 571 00

info@kaller.com



For more information see our website

[www.kaller.com](http://www.kaller.com)

# KALLER®

GAS SPRINGS

USA +1 586 415 6677

Korea +82 31 422 4591

China +86 22 83962995

Mexico +11 5281 81450570